

Creek Courses beg<sup>d</sup> at a W. Walnut.

- N. 55° W. 33.5
- N. 37½° W. 35.
- N. 51° W. 36.
- N. 28° W. 25
- N. 34° W. 55. ps to an Elm.

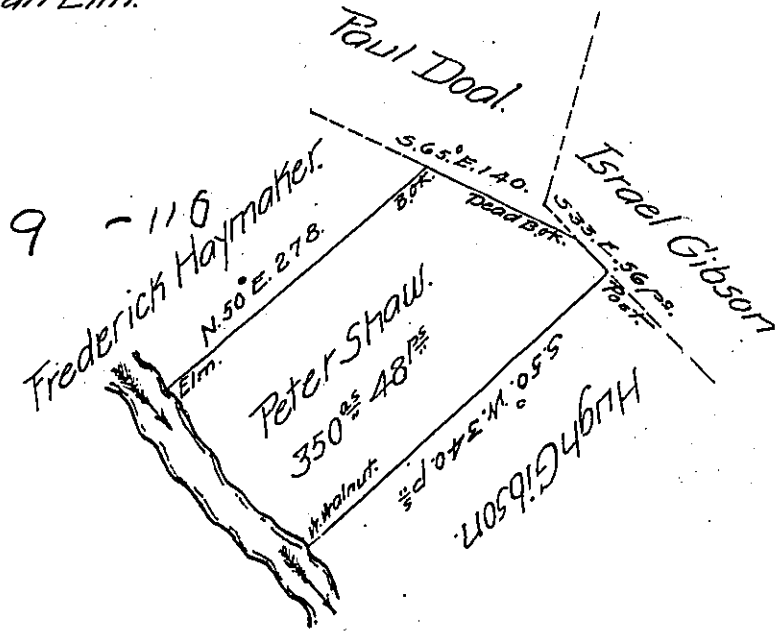

In pursuance of a Warrant for 350<sup>acs</sup> dated the 20<sup>th</sup> day of May 1801, was surveyed the 14<sup>th</sup> day of July for Peter Shaw the above described Tract of land containing 350 Acres 48 perches and allowance of Six per Cent for Roads & Situate on the East side and adjoining French Creek in Mead Township Crawford County, It being the same Tract of Land that was surveyed for the said Peter Shaw the 14<sup>th</sup> day of October 1797 in pursuance of his Improvement bearing date the 16<sup>th</sup> day of October 1795.

William McArthur D. Sr.

To Samuel Cockram Esquire  
Surveyor General.

IN TESTIMONY that the above is a copy of the original remaining on file in the Department of Internal Affairs of Pennsylvania, made conformably to an Act of Assembly approved the 16th day of February, 1833, I have hereunto set my Hand and caused the Seal of said Department to be affixed at Harrisburg, this Twentyfifth day of January 1907.

*James P. Brown*  
Secretary of Internal Affairs.